

# Martindale

## FULL FACEMASK INSTRUCTIONS

(FACEMASK PART No. M08S, M23FF, M23FF/8, M26FFM/2 and M26FFM/3)

---

### THIS FACEMASK CONFORMS WITH EUROPEAN STANDARD EN-136

#### DESCRIPTION – BLUE SILICONE FULL FACEMASK

The facemask is moulded in soft non-dermatic silicone with a contoured reflex edge faceseal and a deep comfortable chin cup. The mask is held firmly and comfortably on the wearer's face by a five-point fully adjustable neoprene head harness.

The flow of air through the mask is managed by means of exhalation and inhalation valves which are mounted within the central front fitting of the mask, and the inner oronasal mask covering the nose and mouth. Air enters the mask through the inlet port, which contains a non-return valve, and is directed over the inside of the visor keeping it free from misting and then into the oronasal mask via its two non-return inhalation valves. Exhaled air leaves the mask directly via the low resistance exhalation valve, which is positioned at the lowest part of the mask.

Immediately in front of the wearer's mouth is the speech diaphragm which allows the clear transmission of audible frequencies.

The mask has a large panoramic visor giving an extremely wide field of vision and has been optically corrected for distortion free vision. This visor is moulded from tough polycarbonate and gives excellent impact protection from high-speed particles.

#### Pre-use Checks

Carefully inspect the mask for any signs of deterioration or damage.

Check that the facemask visor is clean and free from scratches or blemishes likely to cause distortion or other difficulties with vision.

Unclip the Front Cover (8) after removing the Neckstrap Assembly (22/23) and ensure that the Exhalation Valve (17) is in place and free from distortion.

Check that the Inhalation Valve Seat (9) is in place and free from any sign of surface damage, deterioration or distortion and that the Inhale Valve Flap (10) is present.

Replace the front cover and neckstrap assembly.

Fully extend all the Head Harness Straps (19).

#### DONNING THE FACEMASK

- 1 Hang the facemask around the neck by means of neckstrap.
- 2 Fit facemask by placing thumbs inside head harness straps, place chin into chin cup and draw facemask onto face.
- 3 Pull harness over the head, with the common join of the straps placed on the crown of the head.
- 4 Hold the front fitting of the mask in one hand so as to keep the chin in the correct position, tighten the lower straps of the head harness one at a time and then the top strap. Next, tighten the two centre straps and then finally check the two lower straps for tightness and adjust if necessary. The straps should be tightened firmly so as to hold the mask securely onto the face. Over tightening will not improve the seal and will probably cause discomfort.
- 5 To check that the facemask is fitted correctly and that a seal has been achieved, place a palm over the mask inlet, breathe in and hold for 10 seconds. During this time the mask should be pulled onto the face and remain there until the breath is released. If this is not the case, reposition the mask on the face, readjust the straps and repeat the test.

#### DOFFING

- 1 Release the head harness straps by pushing forward on all the head harness buckles until the head harness is fully extended. Pull the mask up and over the head.

#### WHEN USED AS A NEGATIVE PRESSURE RESPIRATOR (EASIFLOW PLUS)

##### APPLICATIONS:

This facemask is designed for use in limited concentration of toxic gases or for highly toxic particles. When used as a stand alone respirator (i.e. not in conjunction with a powered respirator unit or compressed or fresh air system) it must be used in conjunction with the appropriate filter to standards EN 141, EN 143, EN 371 or EN 372. Filters with an EN 148-1 (40mm) thread may be screwed directly into the mask. If used with Martindale's range of 'Fitta' filters then an adapter (M22FH) should be used to hold the filter which then screws into the mask. The level of protection offered depends on the filter fitted or device used with, refer to the instructions supplied with the filter or system.

Care should be taken in the selection of the facemask and filters to ensure that they are adequate for the task anticipated, reference should be made to BS 4275. Health and Safety Executive "Respiratory Protective Equipment a Guide to users" or REF "European Guidelines for Selection and Use of Respiratory Protective Devices".

#### WHEN USED WITH A MAGNUM POWERED RESPIRATOR

The mask should be fitted as described in 'fitting the face mask' section above. The hose connecting the power unit to the face piece should be fitted by tightly screwing in the 40mm nut (EN-148/1) on the end of the hose into the socket on the front of the mask, the bayonet end of the hose is fitted into the outlet of the power unit. Details regarding the use of the mask with the Magnum power unit are given in the instructions supplied with the power unit.

#### WHEN USED WITH THE FRESH AIR SUPPLY SYSTEM

The mask should be fitted as described in 'fitting the face mask' section above. The hose connecting the power unit to the face piece should be fitted by tightly screwing in the 40mm nut (EN-148/1) on the end of the hose into the socket on the front of the mask, the other end of the hose is fitted into the top of the belt connector and locked into place by screwing the nut down on the connector until it is hand tight. For the unpowered system use Full Face Mask with twin air hose - M26FFM/2 and for the powered system use Full Face Mask with twin air hose and overflow valve - M26FFM/3. Details regarding the use of the mask with the fresh air system are given in the instructions supplied with the system.

#### GENERAL

##### CLEANING INSTRUCTIONS

- 1 Remove apparatus. i.e. filter, power unit etc. from the mask.
- 2 Wash the face mask by a short immersion in luke warm water containing a mild detergent and then rinse in clean running water, directing some water through the inhale and exhale valves, it may be found convenient to remove the inner mask (12)
- 3 To sanitise, use a Disinfectant such as Chlorhexidine Gluconate solution at a strength recommended by the manufacturer, the mask should be rinsed thoroughly after disinfecting.
- 4 Shake the mask to remove excess water and hang to dry at normal room temperature. NB The mask should **not** be left in direct sunlight.
- 5 Replace parts if removed for cleaning.
- 6 Polish the visor (3) with a lint free cloth and then replace the visor guard (2) for storage.

## SERVICING AND MAINTENANCE INSTRUCTIONS

This Full Face Mask has a shelf life of 5 years from date of manufacture.

If used, maintained, serviced and inspected according to the procedures detailed in these instructions then the expected in-service life of this product will be up to 10 years. We recommend that the Full Face Mask be serviced and quantitatively leak tested as detailed in EN136 on an annual basis as a minimum.

### MANUFACTURE DATE CODE

The mask is marked with date stamps showing date of manufacture.

The outer mask is marked on the inside with a dial. The year of manufacture is indicated by counting the number of dots in the middle circle starting with the year indicated in the inner circle. For example in the diagram there are 8 dots, dot 1 is 1997 hence dot 8 gives 2004. To find the quarter, count the number of dots in the outer segment corresponding to the most clockwise segment. For example in the diagram (Fig. 1) there are 3 dots hence the outer mask was manufactured in the 3<sup>rd</sup> quarter (2004).

The inner mask and head harness are marked with a dial. The central number indicates the year of manufacture. For example in the diagram the number is 05 signifying a date of manufacture of 2005. To find the month, count the number of dots in the outer ring. For example in the diagram (Fig. 2) there are 3 dots hence the inner mask or head-strap was manufactured in March (2005)



Fig. 1 Outer Mask



Fig. 2 Inner Mask / Head Harness

### Visor

- 1 If the visor (3) is scratched or contaminated so as to impair vision then it should be replaced.
- 2 Unscrew and remove the two visor clamp screws (25) using a posi-drive screwdriver.
- 3 Remove the two halves of the Visor Clamp( 27 & 4 ) from the outer facemask and take out the Visor from its groove. Clean the visor groove in the mask making sure that no loose debris is left in the groove. Even the tiniest particle or hair may cause an unacceptable leak.
- 4 Insert the new replacement visor into the rubber groove on the outer facemask, ensuring that it is positioned centrally by using the alignment marks at the top and bottom of the visor to coincide with those on the underside of the rubber groove on the outer facemask.
- 5 Replace the upper and lower halves of the visor clamp, ensuring that they slide smoothly over the rubber outer facemask and also align centrally with the marks on the underside of the rubber groove on the outer facemask. Replace the two screws and tighten each side one to two turns alternately until the two visor clamps touch and then tighten to secure the visor. **DO NOT OVER TIGHTEN THE SCREWS.**

### Valves

#### Exhalation

The exhalation valve (17) used in the mask is moulded to precise dimensions and needs to be carefully maintained to give optimum performance. The valve needs to be inspected on a regular basis to ensure that it is clean, free from distortion and surface imperfections on its underside.

To remove the exhalation valve for examination, remove the Neckstrap Assembly and unclip the Front Cover. The rubber Stepped Valve should be gently eased off its location pin and inspected for signs of damage or distortion. The valve is replaced by pushing it over the location pin in the valve seat and ensure that it is free to rotate on the pin. The refitted valve should then be flat and sitting on its seat. If the exhale valve seat (15) is removed for inspection or replacement of the o-ring seal then great care must be taken when replacing, ensure that the ears of the seat are located in the recesses of the front fitting (6). Replace the front cover and neckstrap.

#### Inhalation

Three inhalation valves (10) are used in the mask and are identical and interchangeable. Two are located on the insides of the Inner Mask and one in the inlet port. They may be easily removed by pulling each valve off its location pin (11). Inspect for any signs of surface imperfection, warping or stiffness and renew is necessary. Replace the valve by gently stretching the centre hole over the head of its location pin.

IMPORTANT : New valves should be stored in clean dry conditions, out of direct sunlight, and at moderate temperature ( about 15 Deg. C)

#### Head Harness

The Head Harness (18) should be replaced if it shows any sign of ageing or deterioration. Each strap of the head harness is easily removed from the mask by prising the rectangular buckle loop (20) from its groove in the Buckle (19). Fit a new rectangular loop to each strap of the new harness and refit by snapping the loops into each buckle.

#### Spectacles

Prescription spectacles without side arms suitable for use with this Full Face Mask are available (See Limitations Part 9). Contact Martindale for more information.

### LIMITATIONS

- 1 Never alter or modify this respirator as this would void all approvals and may contribute to a reduction in protection for the wearer.
- 2 When used as a negative pressure respirator (Easiflow Plus) or with the Magnum Powered system, this apparatus does not supply oxygen and therefore must not be used in atmospheres containing less than 17% oxygen. (This is not applicable when used with the Fresh Air system).
- 3 This apparatus is not designed for use underwater.
- 4 **WARNING:** Under no circumstances should petroleum spirit, chlorinated degreasing fluids (such as trichloroethylene) or organic based solvent cleaning fluids be used to clean any part of this mask.
- 5 **WARNING :** LEAVE WORK AREA IMMEDIATELY IF:
- 6 an emergency occurs, breathing becomes difficult, dizziness or other distress occurs, you smell or taste the contaminant or sense irritation
- 7 or the respirator becomes damaged.
- 8 When used as a negative pressure respirator (Easiflow Plus) or with the Magnum Powered system, this respirator should never be used in stills, tanks, confined spaces or in any other circumstances where a high concentration of gas is likely to be present, normally higher than 1% by volume for the gases specified.
- 9 Spectacles and full face masks: facemasks depend on a good seal between the mask and the face seal for their effectiveness. The side arms of conventional spectacles will interfere with the seal and seriously reduce the protection provided by a full facemask, hence spectacles with side arms should not be used.
- 10 Training : Health and Safety legislation requires employers to provide suitable information. Instruction and training for their employees, to enable them to make effective use of the measures that are provided to control their exposure to hazardous substances. Where RPE is used, this means that everyone who is involved in the use of the equipment should be appropriately trained. The wearers must be trained in the use of the equipment, how to wear it and what its limitations are. Managers and supervisors must also be aware of why the RPE is being worn and how it should be worn properly. People involved in maintaining, repairing and testing the equipment and in selecting it for use will also need training.
- 11 Facial hair : A good face seal will only be obtained if the skin in the region of the face seal is smooth and without hair. Facial hair will tend to lift the mask off the face and permit inward leakage of the contaminated air. This is also true for beard stubble, and protection can become reduced during the day due to beard growth. The amount by which protection is reduced by the facial hair growth will depend on many factors such as the extent of the hair and the physical work rate. Wearers should not have beards or hair in the region of the face seal.
- 12 Care should be taken when using this facemask in explosive atmospheres and oxygen enriched atmospheres.
- 13 These instructions must be followed at all times. Incorrect usage of this respirator may result in reduced protection for the wearer.
- 14 The respirator should be stored in the packaging provided in a dry uncontaminated atmosphere (R.H. < 60%) preferably between 10 and 30 Deg.C.
- 15 The respirator should be transported in the packaging initially provided.
- 16 Adequate protection may not be provided in certain highly toxic atmospheres, this mask should never be used where the contamination level exceeds the occupational exposure limit of the contaminate x the protection factor of the mask. (Refer to instructions provided with the filter or system for details of the protection factor provided)

**AVAILABLE SPARES PARTS LIST**

**Description:**

Valve Pack  
Visor  
Visor Covers (pack of 20)

**PartNo:**

M08SSVPN  
M08SVN  
M08SVCVN

**EXPLODED VIEW OF FULL FACEMASK**

**PARTS LIST**

ITEM	DESCRIPTION
(1)	OUTER MASK
(2)	VISOR PROTECTOR
(3)	VISOR
(4)	LOWER VISOR CLAMP
(5)	DECAL LABEL
(6)	FRONT FITTING
(7)	FRONT FITTING CLAMP
(8)	FRONT COVER
(9)	INHALE VALVE SEAT
(10)	INHALE VALVE (3 OFF)
(11)	VALVE PIN
(12)	INNER MASK
(13)	INNER MASK INHALE SEAT
(14)	SPEECH DIAPHRAGM
(15)	EXHALE VALVE SEAT
(16)	EXHALE VALVE PIN
(17)	EXHALE VALVE
(18)	HEAD HARNESS
(19)	HEAD HARNESS BUCKLE
(20)	HEAD HARNESS LOOP
(21)	SPEECH DIAPHRAGM ASSY
(22)	NECK STRAP CORD CLIP
(23)	NECK STRAP CORD
(24)	UPPER DECAL PROTECTOR
(25)	VISOR CLAMP SCREWS (2 OFF)
(26)	FRONT FITTING CLAMP SCREWS (4 OFF)
(27)	UPPER VISOR CLAMP
(28)	EXHALE VALVE SEAT O-RING SEAL
(29)	SPEECH DIAPHRAGM SEALING O RING

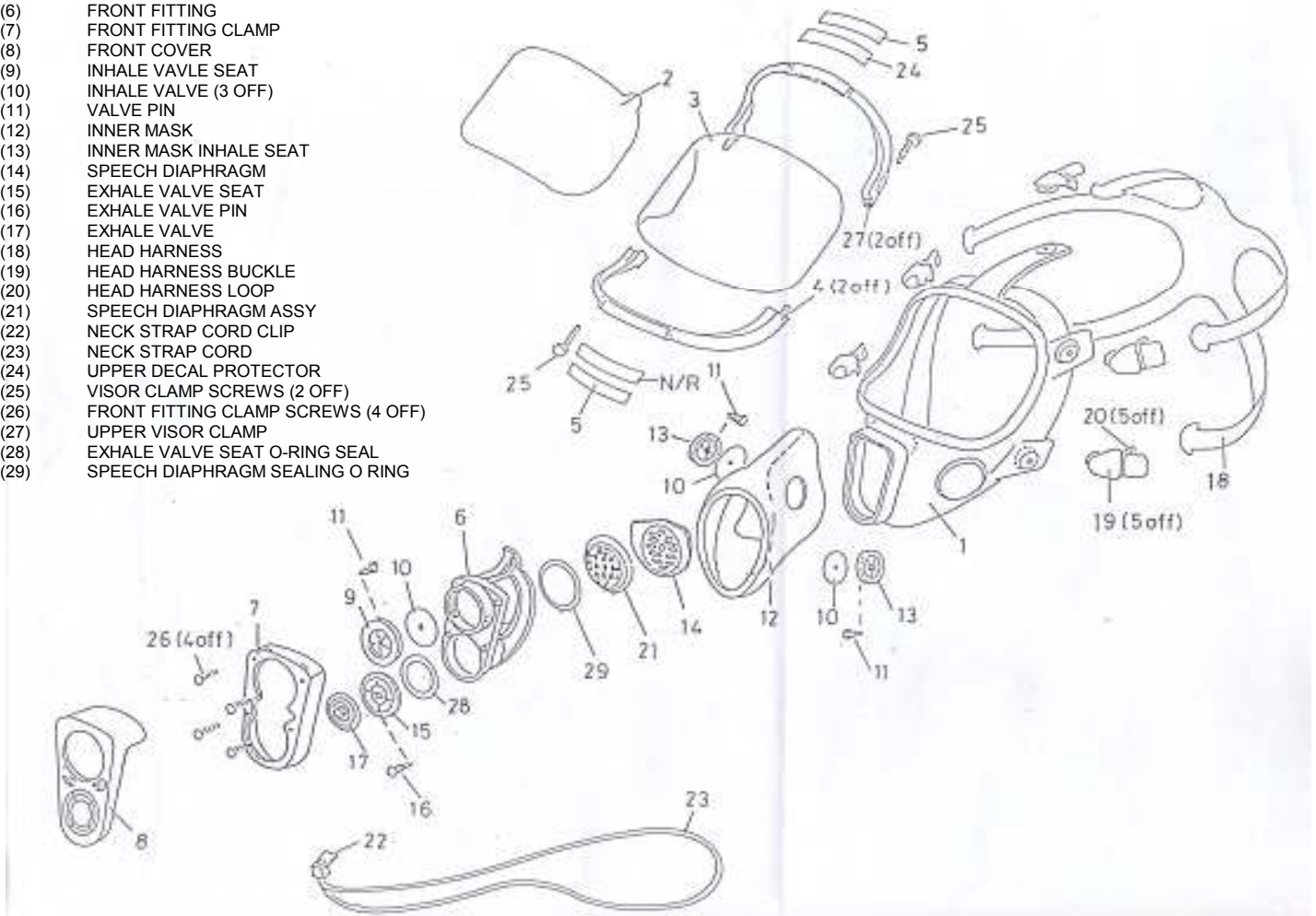

Type-examination by :

BSI Product Services, Maylands Avenue, Hemel Hempstead, Herts, HP2 4SQ (Notified Body No 0086)

All Martindale Full Face Masks are guaranteed free from any faults in materials or workmanship. Should any such faults develop within 12 months of purchase then Centurion Safety Products Ltd will, at their discretion, repair or replace the unit without charge.

**Centurion Safety Products Ltd. Howlett Way, Thetford, Norfolk, IP24 1HZ**  
**Tel. 01842 754266 Fax. 01842 765590**